



API

DEVELOPMENT
CONSULTANTS INC.
ARCHITECTURE & PLANNING INITIATIVES



Brampton, ON - 200 Steewell Road - Hilton Garden Inn & Home 2

Construction Start - Summer 2016

Concept by: Saplys Architects Inc.



Hilton Garden Inn & Hotel Complex - Toronto, Ontario
— Concept By: L. Saplys B. Arch., OAA



SERVICES

- ▾ Site Assessment & Planning
- ▾ Functional Programming
- ▾ Brand Assessment to Client Program
- ▾ Budget Analysis
- ▾ System Budgeting
- ▾ Building Code Consultation
- ▾ Schematic Design for Brand Approvals
- ▾ Design Development for Team Processing
- ▾ Construction Drawing & Specification Review
- ▾ Building Permit Coordination
- ▾ Project Management
- ▾ Project Financial Administration
- ▾ Contract Administration
- ▾ LEED Consulting (Sustainable Design)
- ▾ Construction Management
- ▾ Interior Design
- ▾ Architectural Renderings & Hand Sketches
- ▾ Marketing Drawings



Our **TEAM** provides a multi-talented and experienced foundation in the studio and on the construction site. Our modest sized firm of 23 talented team members offers our client's exceptional service and attention to detail. Each associate brings reliable expertise to the project and its development process with their comprehensive knowledge and a diverse and formulated approach.

Edmonton Airport Master Site Plan - Edmonton, Alberta
 —Concept By: L. Saplys B. Arch., AAA



TownePlace
SUITES
Marriott

TownePlace Suites
Marriott

Marriott Towne Place & Suites - Brantford, Ontario
— Concept By: L. Saplys B. Arch., OAA





Before



Holiday Inn Express & Suites - Halifax, Nova Scotia

—Concept By: L. Saplys B. Arch., NSAA



Before



Delta by Marriott Hotels - Indianapolis, Indiana
Concept By: L. Saplys B. Arch., NCARB



Memory Care Assisted Living - Burlington, Ontario
— Concept By: L. Saplys B. Arch., OAA





Memory Care Assisted Living - Oakville, Ontario
- Concept By: L. Saplys B. Arch., OAA

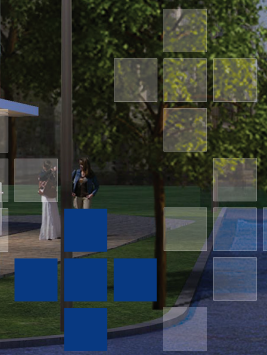



Before

Lord Berri, Fairfiled Inn & Suites - Montreal, Québec
- Concept By: L. Saplys B. Arch.



Before

Quality Inn Conversion to Marriott Courtyard - Oshawa, Ontario
- Concept By: L. Saplys B. Arch., OAA

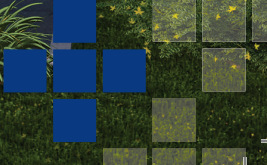



Before

Radisson Renovation to Hilton Double Tree - Toronto, Ontario

— Concept By: L. Saplys B. Arch., OAA



Before

Super 8 Conversion to Sheraton Four Points - Vaughan, Ontario
- Concept By: L. Saplys B. Arch., OAA



COMPLETED PROJECTS IN 2015



Hampton Inn & Suites - Saskatoon, Alberta



Hampton Inn - Sarnia, Ontario



Home 2 by Hilton - Milton, Ontario



Holiday Inn Express - Oshawa, Ontario



Hampton Inn - Timmins, Ontario



Vitality MD Office - Toronto, Ontario



Marriott TownePlace & Suites - Kincardine, Ontario



Marriott Courtyard - Saskatoon, Alberta

CAPITAL POINTE, REGINA, SK - CONDO RESIDENCE INTERIOR & EXTERIOR DESIGN RENDERINGS

—Concept By: L. Saplys B. Arch., OAA





API DEVELOPMENT CONSULTANTS INC
ARCHITECTURE & PLANNING INITIATIVES

1282 Cornwall Rd., Oakville, On, L6J 7W5

Tel. 905-337-7249

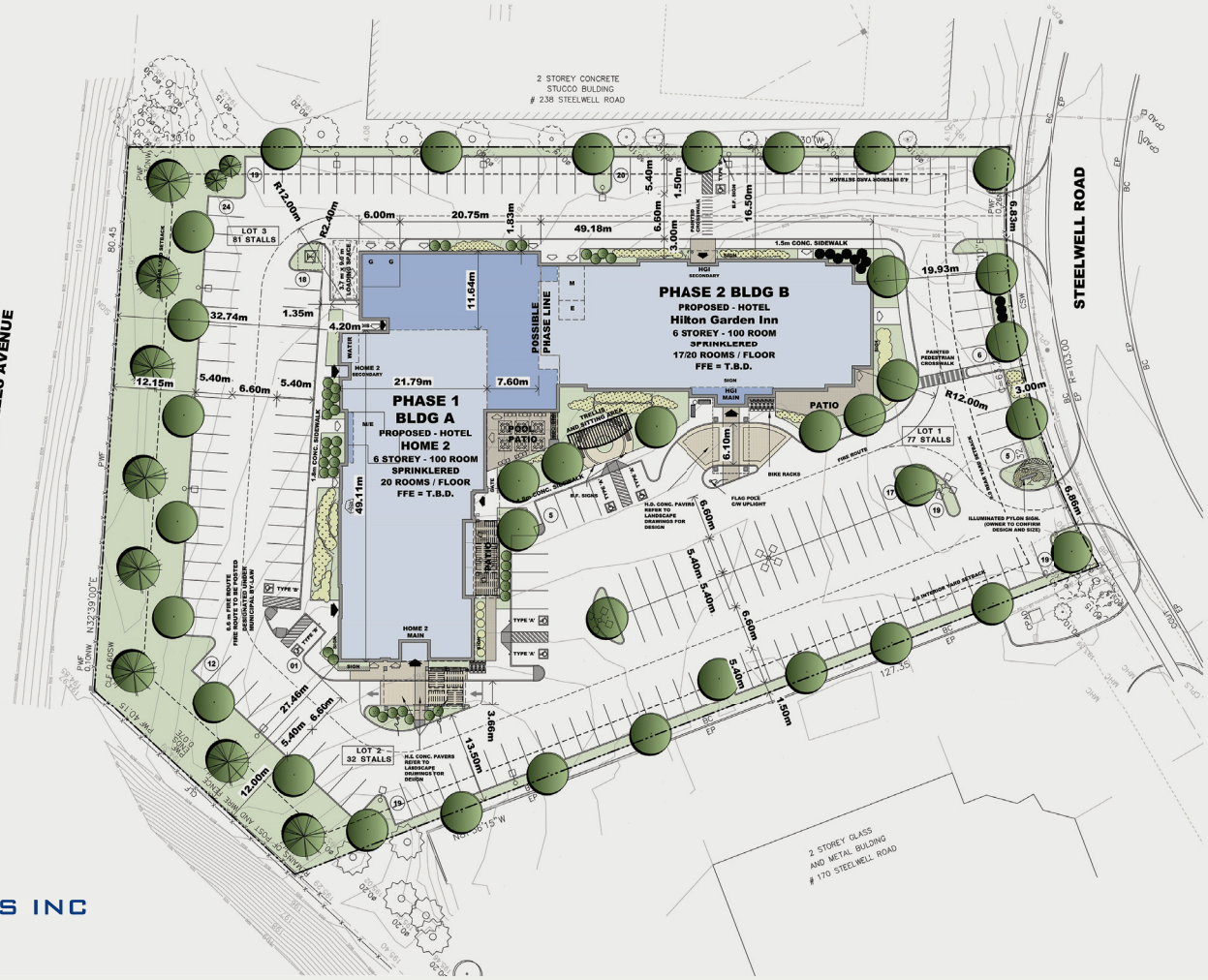

Visit us at www.apidevelopmentconsultants.com